

first for homes

first for property in life - firstforhomes.co.uk

Contact Allan England's Team

01592 752 944



Woodlea Grove, Glenrothes
Offers over £74,995

Woodlea Grove, Glenrothes

Ideal First-Time Purchase or Buy-To-Let Investment - Lovely 2-Bed 2nd Floor Apartment, Situated Within A Desirable Area Of Glenrothes!

Allan England's award winning team at first for homes welcome to the market this lovely bright and spacious 2-bed 2nd Floor Apartment situated within the desirable area of Woodside, Glenrothes. The property is ready to move in to and offers accommodation comprising: secure entry system, entrance hall, inviting lounge with feature glass brick wall, generous kitchen with integrated oven/hob, 2 spacious bedrooms and family bathroom. Externally the property benefits from a private parking area. Situated in a central popular area, close to local amenities, doctors surgery and restaurants. Early viewing is recommended to ensure you don't miss out!

HOME REPORT VALUE £80,000
EPC RATING- D
COUNCIL TAX BAND- C

Call first for homes - first for trust... first for service... first for aftercare.

Glenrothes is regarded as one of the most successful Towns in Scotland with a wealth of local amenities including Kingdom Shopping Centre as well as sport and leisure at Michael Woods and a multi-screen cinema. Glenrothes boasts its very own 18-hole Golf course and both Primary and Secondary schooling are available. For the commuter the A92 allows swift access to Edinburgh and there are railway stations at both Thornton and Markinch.

INFORMATION These particulars are prepared on the basis of information provided by our clients. We have not tested the electrical system or appliances, nor where applicable, any central heating system. All sizes are recorded by electronic tape measurements to give an indicative, approximate size only. Prospective purchasers should make their own enquiries - no warranty is given or implied. This schedule is not intended to, and does not form any contract.





SITUATION – Glenrothes

ENTRANCE HALLWAY

LOUNGE

13'11" x 12'3" (approx) (4.25m x 3.74m (approx))

KITCHEN 8'7" x 7'6" (approx) (2.62m x 2.31m (approx))

BEDROOM 1

10'9" x 8'7" (approx) (3.28m x 2.64m (approx))

BEDROOM 2

9'4" x 8'10" (approx) (2.87m x 2.71m (approx))

BATHROOM

6'4" x 6'2" (approx) (1.94m x 1.90m (approx))

STREET PARKING

INFORMATION



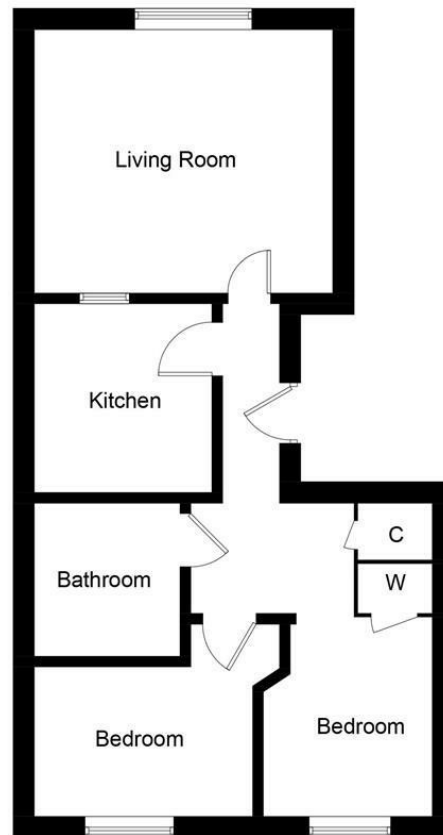

Second Floor

Illustration for identification purposes only, measurements are approximate, not to scale. Fourlabs.co © (ID1275322)

Information

These particulars are prepared on the basis of information provided by our clients. We have not tested the electrical system or any electrical appliances, nor where applicable, any central heating system. All sizes are recorded by electronic tape measurement to give an indicative, approximate size only. Prospective purchasers should make their own enquiries – no warranty is given or implied. This schedule is not intended to, and does not form any contract.

FREE Valuation

Selling Your Home?

Choose first for homes - a highly experienced estate agency team you can trust to sell your home at the highest possible price. Offering fantastic savings on selling fees, with no compromise on service, free professional photography highlighting your home in its best light, first for homes will be your first choice. Contact us today to arrange your appointment.



first for trust



first for service



first for aftercare

first for homes
first for property in life - firstforhomes.co.uk

Contact Allan England's Team
01592 752 944

32 North Street, Glenrothes, Fife KY7 5NA
Fax: 01592 807947
sales@firstforhomes.co.uk
www.firstforhomes.co.uk